

10/03/13

CONTRACT NO.: DA00295 WBS ELEMENT: 2016CPT.01.26.20151.1, ETC

STATE OF NORTH CAROLINA
DIVISION OF HIGHWAYS

CAMDEN COUNTY

STATE	STATE PROJECT REFERENCE NO.	SHEET NO.	TOTAL SHEETS
N.C.	2016CPT.01.26.20151.1, ETC	1	1
STATE PROJ. NO.	F.A. PROJ. NO.	DESCRIPTION	
2016CPT.01.26.20151.1		MAP 1	
2016CPT.01.26.20151.2		MAP 2	
2016CPT.01.26.20151.3		MAP 3	
2016CPT.01.26.20151.4		MAP 4	
2016CPT.01.26.20151.5		MAP 5	
2016CPT.01.26.20151.6		MAP 6	
2016CPT.01.26.20151.7		MAP 7	
2016CPT.01.26.20151.8		MAP 8	
2016CPT.01.26.20151.9		MAP 9	

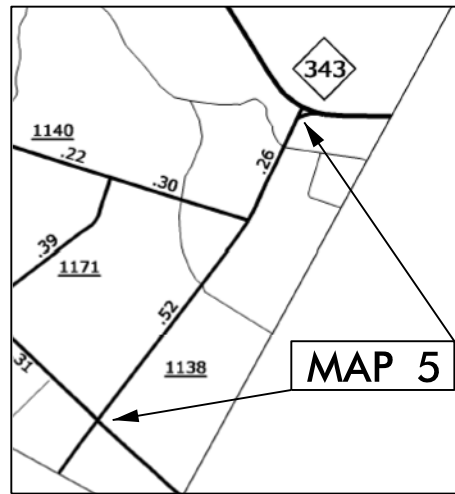

- LOCATION:**
- MAP 1 SR 1221 SPENCE LN. FROM SR 1219 TO DEAD END
 - MAP 2 SR 1235 CAROLINA RD. FROM SR 1223 TO DEAD END
 - MAP 3 SR 1229 STINGY LN. FROM SR 1224 TO END OF PAVEMENT
 - MAP 4 SR 1251 OLD US 17 FROM US 17 TO PASQUOTANK COUNTY LINE
 - MAP 5 SR 1138 SEYMOUR RD. FROM NC 343 TO SR 1132
 - MAP 6 SR 1231 MCPHERSON RD. FROM SR 1233 TO US 17
 - MAP 7 SR 1228 GALLBURY RD. FROM SR 1232 TO DEAD END
 - MAP 8 SR 1249 STILES RD. FROM SR 1224 TO DEAD END
 - MAP 9 SR 1234 CARTWRIGHT RD. FROM SR 1224 TO DEAD END

TYPE OF WORK: RESURFACING & SHOULDER RECONSTRUCTION

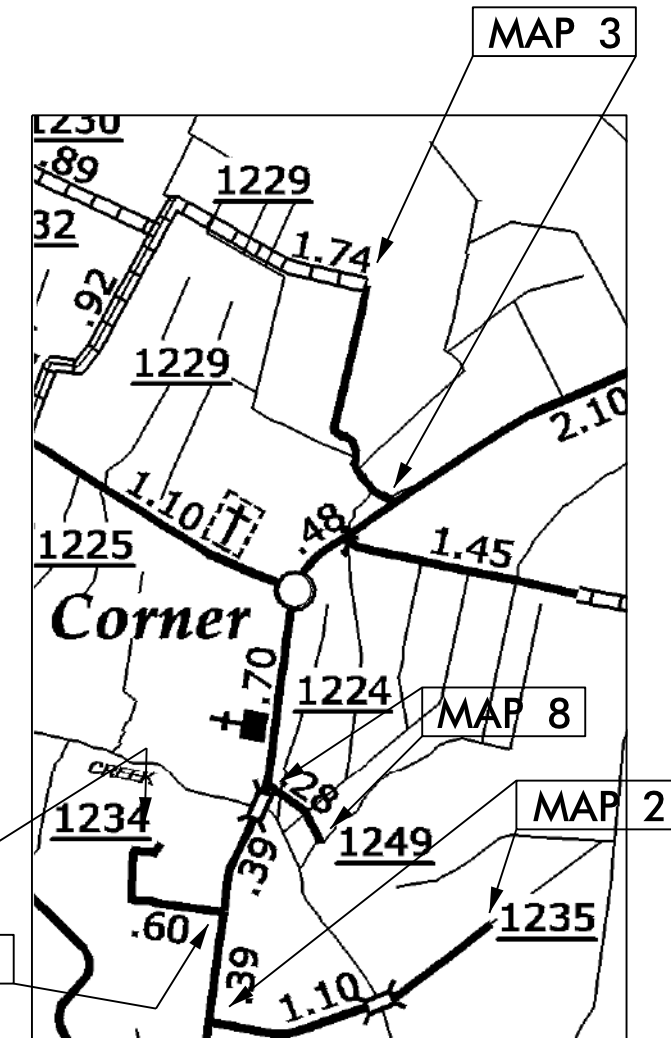
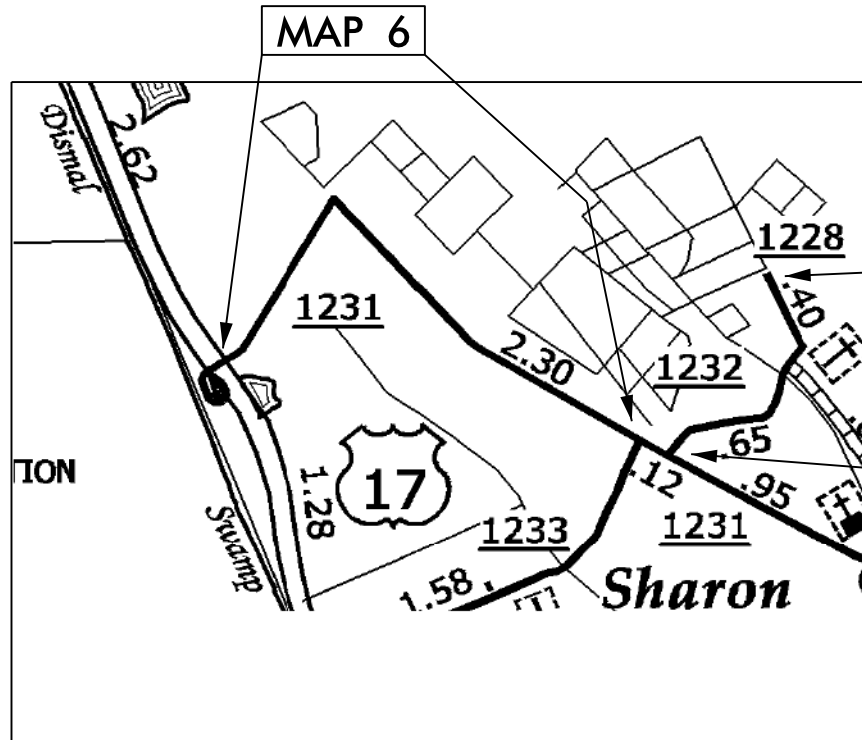
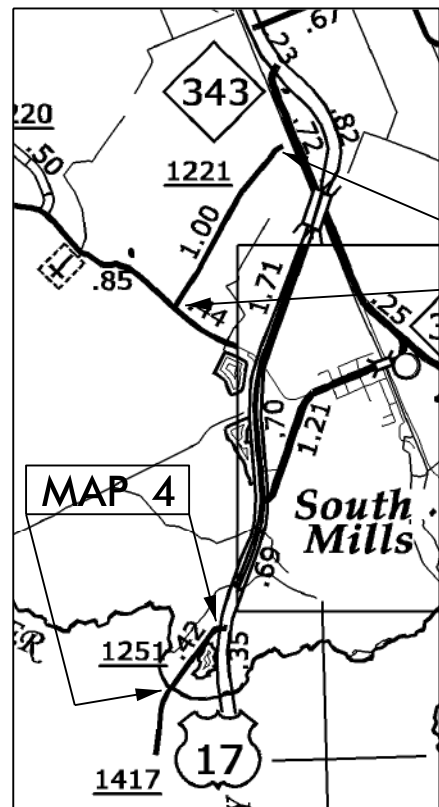

NTS

PROJECT LENGTH

LENGTH OF ROADWAY PROJECT	MAP 1 = 1.03 MI.
LENGTH OF ROADWAY PROJECT	MAP 2 = 0.9 MI.
LENGTH OF ROADWAY PROJECT	MAP 3 = 0.81 MI.
LENGTH OF ROADWAY PROJECT	MAP 4 = 0.44 MI.
LENGTH OF ROADWAY PROJECT	MAP 5 = 0.75 MI.
LENGTH OF ROADWAY PROJECT	MAP 6 = 2.21 MI.
LENGTH OF ROADWAY PROJECT	MAP 7 = 0.39 MI.
LENGTH OF ROADWAY PROJECT	MAP 8 = 0.26 MI.
LENGTH OF ROADWAY PROJECT	MAP 9 = 0.47 MI.

Prepared In the Office of:
DIVISION OF HIGHWAYS
113 Airport Dr., Edenton NC, 27932

2012 STANDARD SPECIFICATIONS

LETTING DATE:

W. B. HOBBS, P.E.
DIVISION PROJECT MANAGER

C. E. SLACHTA
DIVISION PROPOSALS ENGINEER

DIVISION OF HIGHWAYS
STATE OF NORTH CAROLINA

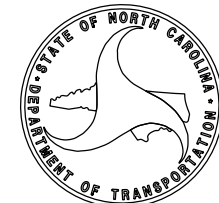

DRAWN BY: JWC

10/03/13

CONTRACT NO.: DA00295 WBS ELEMENT: 2016CPT.01.26.2015I.1, ETC.

STATE OF NORTH CAROLINA
DIVISION OF HIGHWAYS

CURRITUCK COUNTY

STATE	STATE PROJECT REFERENCE NO.	SHEET NO.
N.C.	2016CPT.01.26.2015I.1, ETC.	2
STATE PROJ. NO.	F.A. PROJ. NO.	DESCRIPTION
2016CPT.01.26.20271.1		MAP 10
2016CPT.01.26.20271.2		MAP 11
2016CPT.01.26.20271.3		MAP 12
2016CPT.01.26.20271.4		MAP 13
2016CPT.01.26.20271.5		MAP 14
2016CPT.01.26.20271.6		MAP 15

LOCATION: MAP 10 SR 1245 BELL'S ISLAND RD. FROM NC 168 TO PAVEMENT CHANGE
 MAP 11 SR 1347 ROWLAND CREEK RD. FROM NC 168 TO CUL-DE-SAC
 MAP 12 SR 1246 MAPLE RD. FROM US 158 TO NC 168
 MAP 13 SR 1202 SNOWDEN RD. FROM NC 168 TO .68 MILES SOUTH TO WIDTH CHANGE
 MAP 14 SR 1203 EAST RIDGE RD. FROM NC 168 TO SR 1209
 MAP 15 SR 1346 EQUESTRIAN DR. FROM SR 1203 TO CUL-DE-SAC

TYPE OF WORK: RESURFACING & SHOULDER RECONSTRUCTION

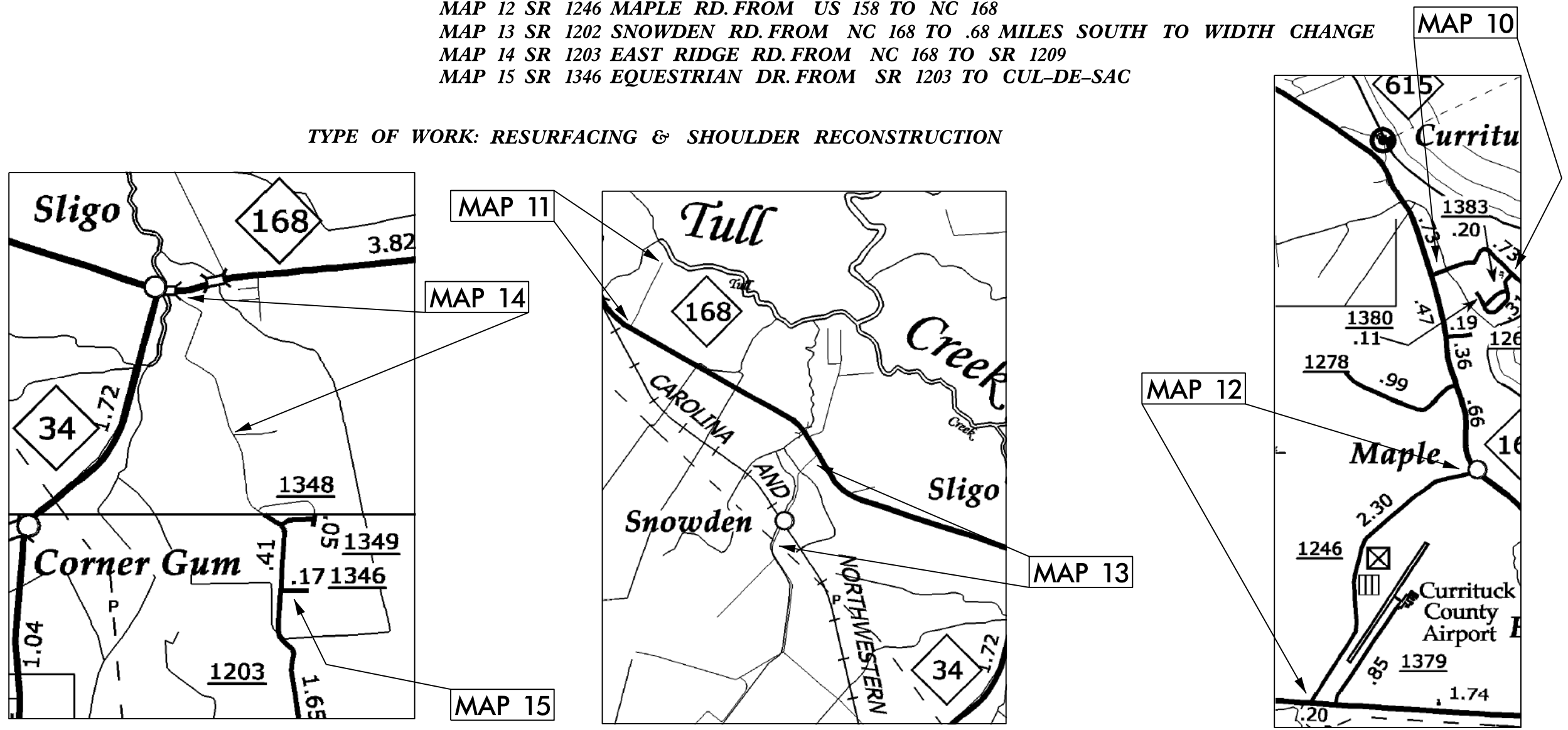

NTS

PROJECT LENGTH	
LENGTH OF ROADWAY PROJECT	MAP 10 = 1.46 MI.
LENGTH OF ROADWAY PROJECT	MAP 11 = 0.53 MI.
LENGTH OF ROADWAY PROJECT	MAP 12 = 2.3 MI.
LENGTH OF ROADWAY PROJECT	MAP 13 = 0.69 MI.
LENGTH OF ROADWAY PROJECT	MAP 14 = 1.09 MI.
LENGTH OF ROADWAY PROJECT	MAP 15 = 0.17 MI.

Prepared in the Office of:
DIVISION OF HIGHWAYS
 113 Airport Dr., Edenton NC, 27932

2012 STANDARD SPECIFICATIONS

LETTING DATE: _____

W.B. HOBBS, P.E.
 DIVISION PROJECT MANAGER

C.E. SLACHTA
 DIVISION PROPOSALS ENGINEER

**DIVISION OF HIGHWAYS
 STATE OF NORTH CAROLINA**

DRAWN BY: JWC

CONTRACT NO.: DA00295 WBS ELEMENT: 2016CPT.01.26.20151.1, ETC.

STATE OF NORTH CAROLINA
DIVISION OF HIGHWAYS

PASQUOTANK COUNTY

STATE	STATE PROJECT REFERENCE NO.	SHEET NO.
N.C.	2016CPT.01.26.20151.1, ETC	3
STATE PROJ. NO.	F.A. PROJ. NO.	DESCRIPTION
2016CPT.01.26.20701.1		MAP 16
2016CPT.01.26.20701.2		MAP 17
2016CPT.01.26.20701.3		MAP 18
2016CPT.01.26.20701.4		MAP 19
2016CPT.01.26.20701.5		MAP 20
2016CPT.01.26.20701.6		MAP 21
2016CPT.01.26.20701.7		MAP 22
2016CPT.01.26.20701.8		MAP 23

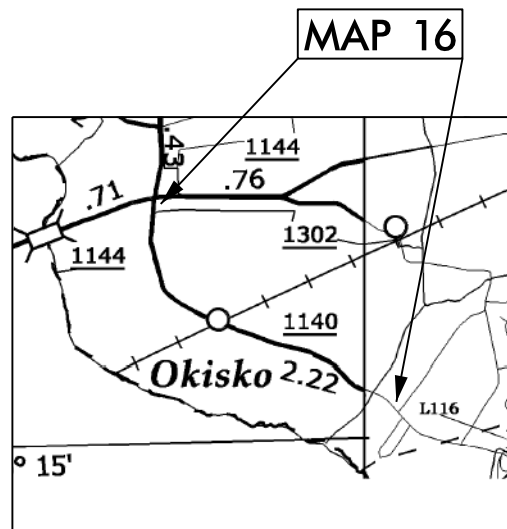

LOCATION: MAP 16 SR 1302 PASQUOTANK STATION RD. FROM SR 1300 TO SR 1144
 MAP 17 SR 1417 MORGANS CORNER RD. FROM US 158 TO COUNTY LINE
 MAP 18 SR 1416 NORTHSIDE RD. FROM US 17 SOUTH 2.8 MILES TO CHANGE IN PAVEMENT
 MAP 19 SR 1454 JENNIFER DR. FROM SR 1456 TO CUL-DE-SAC
 MAP 20 SR 1463 JASON DR. FROM SR 1456 TO CUL-DE-SAC
 MAP 21 SR 1450 MEGAN DR. FROM SR 1140 TO DEAD END
 MAP 22 SR 1453 STACIE DR. FROM SR 1450 TO SR 1456
 MAP 23 SR 1456 BETTY DR. FROM SR 1461 TO SR 1374

TYPE OF WORK: RESURFACING, WIDENING & SHOULDER RECONSTRUCTION

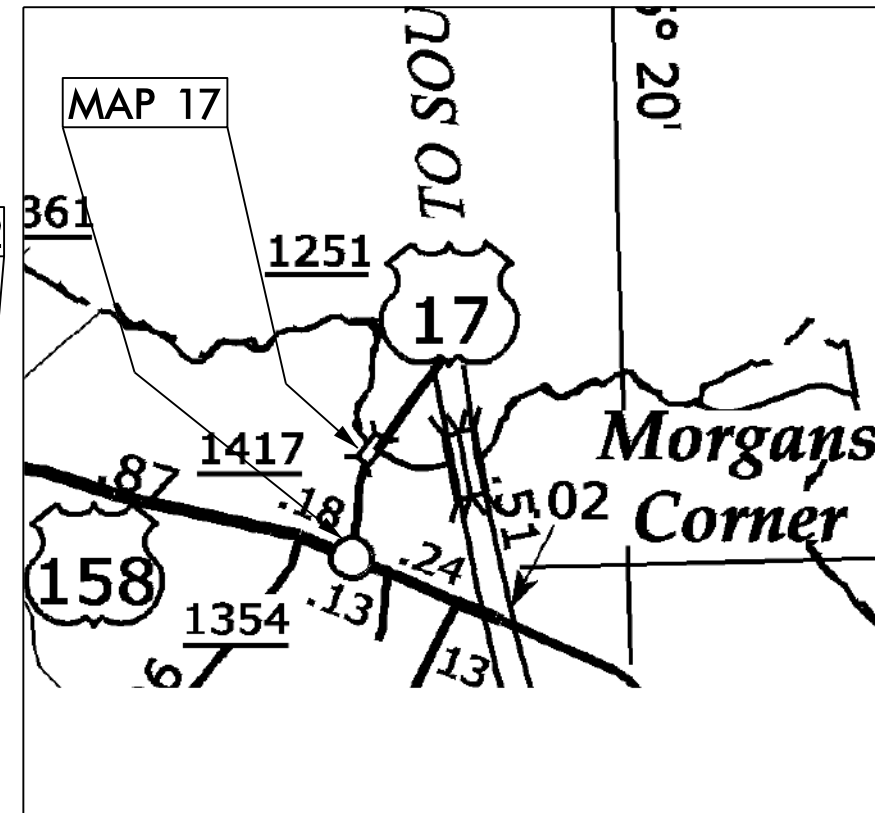
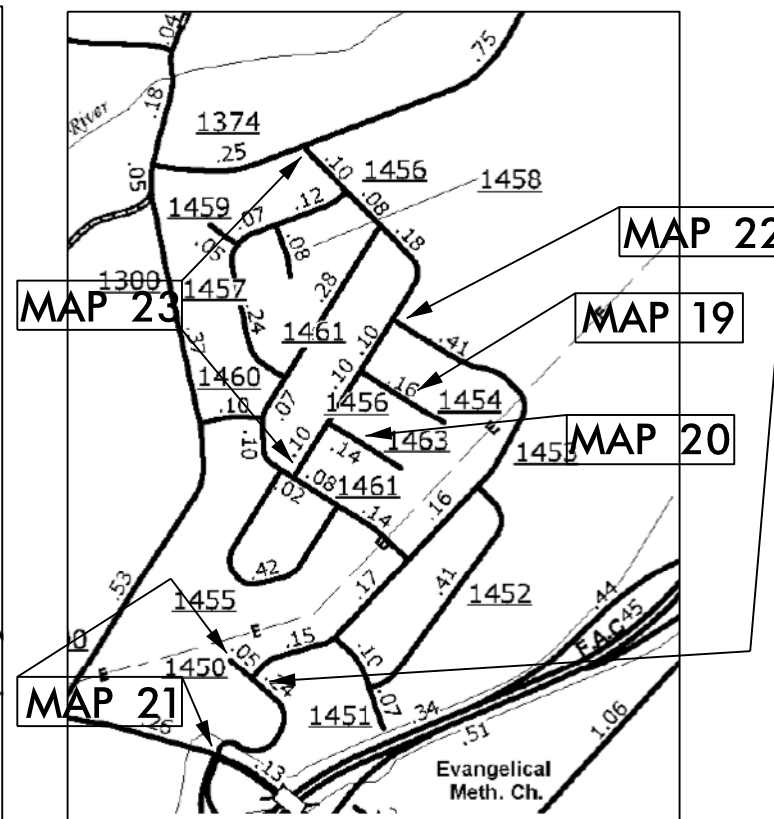
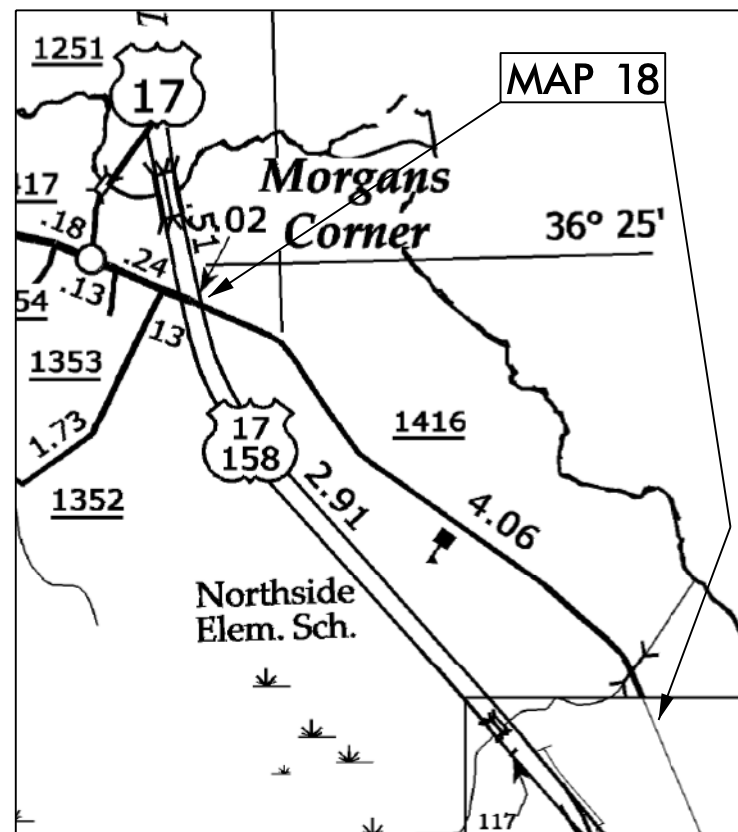

NTS

PROJECT LENGTH

LENGTH OF ROADWAY PROJECT	MAP 16 = 1.48 MI.
LENGTH OF ROADWAY PROJECT	MAP 17 = 0.33 MI.
LENGTH OF ROADWAY PROJECT	MAP 18 = 2.8 MI.
LENGTH OF ROADWAY PROJECT	MAP 19 = 0.15 MI.
LENGTH OF ROADWAY PROJECT	MAP 20 = 0.14 MI.
LENGTH OF ROADWAY PROJECT	MAP 21 = 0.28 MI.
LENGTH OF ROADWAY PROJECT	MAP 22 = 0.88 MI.
LENGTH OF ROADWAY PROJECT	MAP 23 = 0.64 MI.

Prepared in the Office of:
DIVISION OF HIGHWAYS
113 Airport Dr., Edenton NC, 27932

2012 STANDARD SPECIFICATIONS

LETTING DATE: _____

W.B. HOBBS, P.E.
DIVISION PROJECT MANAGER

C.E. SLACHTA
DIVISION PROPOSALS ENGINEER

DIVISION OF HIGHWAYS
STATE OF NORTH CAROLINA

C O N T R A C T P A V E M E N T S C H E D U L E

C1	PROP. APPROX. 1¼" ASPHALT CONCRETE SURFACE COURSE, TYPE SF9.5A, AT AN AVERAGE RATE OF 137.5 LBS. PER SQ. YD.
C2	PROP. APPROX. 1¼" ASPHALT CONCRETE SURFACE COURSE, TYPE S9.5B, AT AN AVERAGE RATE OF 140 LBS. PER SQ. YD.
U	EXISTING PAVEMENT.
T	EARTH MATERIAL.

P A V E M E N T S C H E D U L E

C1	PROP. APPROX. 1 1/4" ASPHALT CONCRETE SURFACE COURSE, TYPE SF9.5A, AT AN AVERAGE RATE OF 137.5 LBS. PER SQ. YD.
U	EXISTING PAVEMENT.
T	EARTH MATERIAL

PROJECT REFERENCE NO.	SHEET NO.
2016CPT.01.26.20151.1, ETC	5

NOTES:

*ALL PAVED S.R. ROADS TO BE RESURFACED TO THE ENDS OF THE RADII, OR AS DIRECTED BY THE ENGINEER

*EDGES, PAVEMENT WIDENING, INTERSECTIONS, AND BRIDGE FLARES ARE INCLUDED IN THE TABLE OF QUANTITIES

*PAVEMENT MARKINGS TO BE INSTALLED BY OTHERS

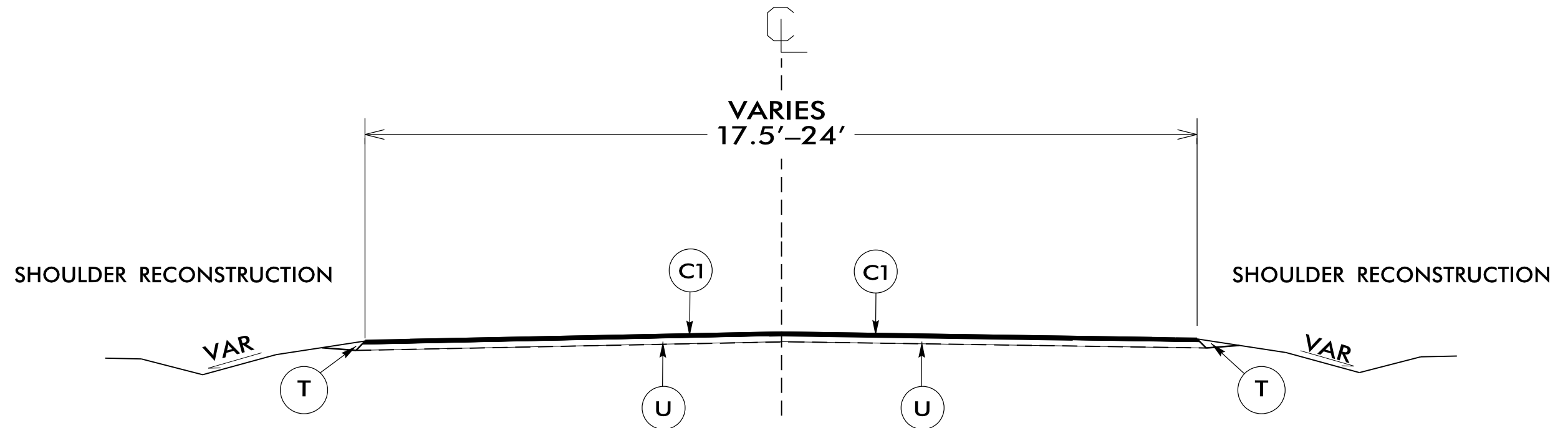

TYPICAL SECTION NO. 1
USE WITH MAPS 1-3, 5-16, 18-23

NTS

P A V E M E N T S C H E D U L E

C2	PROP. APPROX. 1 1/4" ASPHALT CONCRETE SURFACE COURSE, TYPE S9.5B, AT AN AVERAGE RATE OF 140 LBS. PER SQ. YD.
U	EXISTING PAVEMENT.
T	EARTH MATERIAL

PROJECT REFERENCE NO.	SHEET NO.
2016CPT.01.26.20151.1, ETC.	6

NOTES:

*ALL PAVED S.R. ROADS TO BE RESURFACED TO THE ENDS OF THE RADII, OR AS DIRECTED BY THE ENGINEER

*EDGES, PAVEMENT WIDENING, INTERSECTIONS, AND BRIDGE FLARES ARE INCLUDED IN THE TABLE OF QUANTITIES

*PAVEMENT MARKINGS TO BE INSTALLED BY OTHERS

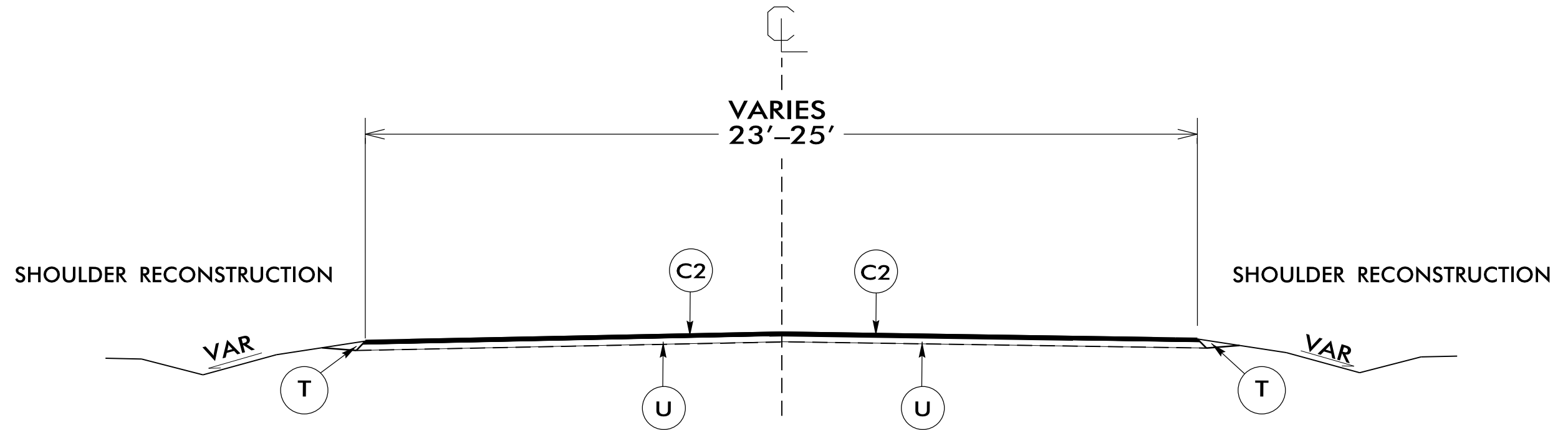

TYPICAL SECTION NO. 2

USE WITH MAPS 4 & 17

NTS

PROJECT NO.	SHEET NO.	TOTAL NO.
2016CPT.01.26.20151.1, ETC.	7	

SUMMARY OF QUANTITIES

PROJECT NO	COUNTY	MAP NO	ROUTE	DESCRIPTION	TYP	LANES	LANE TYPE	FINAL SURFACE TESTING REQUIRED	WARM MIX ASPHALT REQUIRED	LENGTH	WIDTH	MOBILIZATION	BORROW	INCIDENTAL STONE BASE	SHOULDER RECONSTRUCTION	INCIDENTAL MILLING	SURFACE COURSE, S9.5B	SURFACE COURSE, SF9.5A	ASPHALT BINDER FOR PLANT MIX	ADJ. OF METER OR VALVE BOX	SEED & MULCHING	TRAFFIC CONTROL
										MI	FT	LS	CY	TONS	SMI	SY	TONS	TONS	TONS	EA	AC	LS
2016CPT.01.26.20151.1	Camden	1	SR 1221 SPENCE LANE	FROM SR 1219 TO DEAD END	1	2	2WU	NO	NO	1.03	18.5	1	400	20	2.00			872	58		1.00	1
2016CPT.01.26.20151.2	Camden	2	SR 1235 CAROLINA ROAD	FROM SR 1223 TO DEAD END	1	2	2WU	NO	NO	0.9	18.5	*	360	25	1.80	200		765	51		0.87	*
2016CPT.01.26.20151.3	Camden	3	SR 1229 STINGY LANE	FROM SR 1224 TO END OF PAVEMENT	1	2	2WU	NO	NO	0.81	20.5	*	320	10	1.60			762	51		0.77	*
2016CPT.01.26.20151.4	Camden	4	SR 1251 OLD US 17	FROM US 17 TO PASQUOTANK COUNTY LINE	2	2	2WU	NO	NO	0.44	25	*	170	11	0.88	250	599		36		0.40	*
2016CPT.01.26.20151.5	Camden	5	SR 1138 SEYMOUR ROAD	FROM NC 343 TO SR 1132	1	2	2WU	NO	NO	0.75	19	*	300	27	1.50			636	43		0.72	*
2016CPT.01.26.20151.6	Camden	6	SR 1231 MCPHERSON RD	FROM SR 1233 TO US 17	1	2	2WU	NO	NO	2.21	20	*	800	52	4.40			2,015	135		2.10	*
2016CPT.01.26.20151.7	Camden	7	SR 1228 GALLBURY RD	FROM SR 1232 TO DEAD END	1	2	2WU	NO	NO	0.39	19	*	150	10	0.75			331	22		0.35	*
2016CPT.01.26.20151.8	Camden	8	SR 1249 STILES ROAD	FROM SR 1224 TO DEAD END	1	2	2WU	NO	NO	0.26	17.5	*	100	10	0.50			203	14		0.25	*
2016CPT.01.26.20151.9	Camden	9	SR 1234 CARTWRIGHT RD	FROM SR 1224 TO DEAD END	1	2	2WU	NO	NO	0.47	19	*	180	5	0.90			442	30		0.43	*
2016CPT.01.26.20271.1	Currituck	10	SR 1245 BELL'S ISLAND ROAD	FROM NC 168 TO PAVEMENT CHANGE	1	2	2WU	NO	NO	1.46	20	*	500	30	2.80	900		1,313	88		1.40	*
2016CPT.01.26.20271.2	Currituck	11	SR 1347 ROWLAND CREEK RD	FROM NC 168 TO CUL-DE-SAC	1	2	2WU	NO	NO	0.53	18	*	200	20	1.00			448	30		0.50	*
2016CPT.01.26.20271.3	Currituck	12	SR 1246 MAPLE RD	FROM US 158 TO NC 168	1	2	2WU	NO	NO	2.3	20	*	800	20	4.60			2,062	138		2.20	*
2016CPT.01.26.20271.4	Currituck	13	SR 1202 SNOWDEN ROAD	FROM NC 168 TO .68 MILES SOUTH TO WIDTH CHANGE	1	2	2WU	NO	NO	0.69	15	*	200	15	1.30			484	32		0.63	*
2016CPT.01.26.20271.5	Currituck	14	SR 1203 EAST RIDGE RD	FROM NC 168 TO SR 1209	1	2	2WU	NO	NO	1.09	18	*	400	15	2.00			876	59		1.00	*
2016CPT.01.26.20271.6	Currituck	15	SR 1346 EQUESTRIAN DR	FROM SR 1203 TO CUL-DE-SAC	1	2	2WU	NO	NO	0.17	20	*	40	10	0.34			152	10		0.40	*
2016CPT.01.26.20701.1	Pasquotank	16	SR 1302 PASQUOTANK STATION RD	FROM SR 1300 TO SR 1144	1	2	2WU	NO	NO	1.48	20	*	600	60	2.96			1,375	92	1	2.50	*
2016CPT.01.26.20701.2	Pasquotank	17	SR 1417 MORGANS CORNER RD	FROM US 158 TO COUNTY LINE	2	2	2WU	NO	NO	0.33	23	*	100		0.66	250	414		25		0.50	*
2016CPT.01.26.20701.3	Pasquotank	18	SR 1416 NORTHSIDE RD	FROM US 17 SOUTH 2.8 TO CHANGE IN PAVEMENT	1	2	2WU	NO	NO	2.8	24	*	1,000	50	5.60			3,214	215		2.70	*
2016CPT.01.26.20701.4	Pasquotank	19	SR 1454 JENNIFER DR	FROM SR 1456 TO CUL-DE-SAC	1	2	2WU	NO	NO	0.15	18	*	60	2	0.30			175	12		0.25	*
2016CPT.01.26.20701.5	Pasquotank	20	SR 1463 JASON DR	FROM SR 1456 TO CUL-DE-SAC	1	2	2WU	NO	NO	0.14	18	*	60	2	0.28			134	9		0.20	*
2016CPT.01.26.20701.6	Pasquotank	21	SR 1450 MEGAN DR	FROM SR 1140 TO DEAD END	1	2	2WU	NO	NO	0.28	20	*	100	2	0.50			294	20	1	0.50	*
2016CPT.01.26.20701.7	Pasquotank	22	SR 1453 STACIE DR	FROM SR 1450 TO SR 1456	1	2	2WU	NO	NO	0.88	21	*	300	5	1.76			934	63	2	1.49	*
2016CPT.01.26.20701.8	Pasquotank	23	SR 1456 BETTY DR	FROM SR 1461 TO SR 1374	1	2	2WU	NO	NO	0.64	21	*	225	2	1.28			709	48	3	1.00	*
GRAND TOTAL										20.2		1	7,365	403	39.71	1,600	1,013	18,196	1,281	7	22.16	1

- NOTES:
- 1) DETAIL DOES NOT APPLY TO OGAFc AND ULTRA-THIN BONDED WEARING COURSE.
 - 2) BACKFILL SHOULDER WITH APPROVED MATERIAL.
 - 3) THE SHOULDER WEDGE DEVICE MAY BE DISENGAGED AT PAVED DRIVEWAYS AND SIDE STREETS.

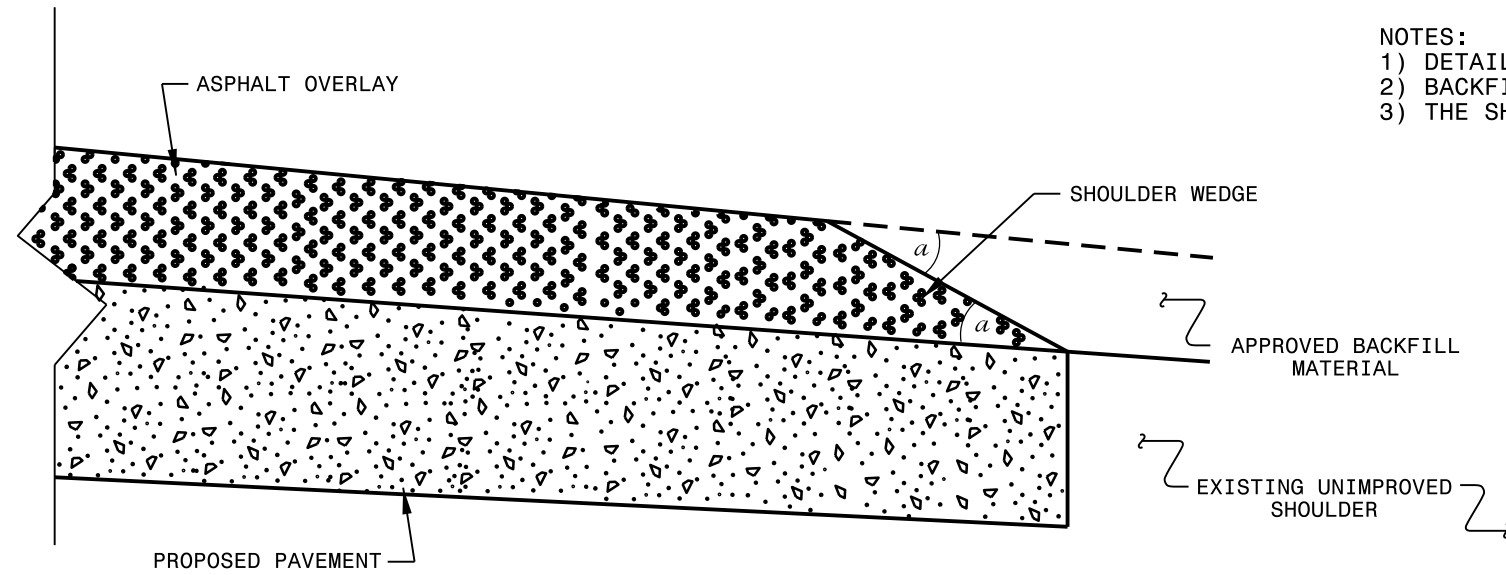

SHOULDER WEDGE DETAIL
(Resurfacing Projects w/ Widening or
with Existing Paved Shoulder having no dropoffs)

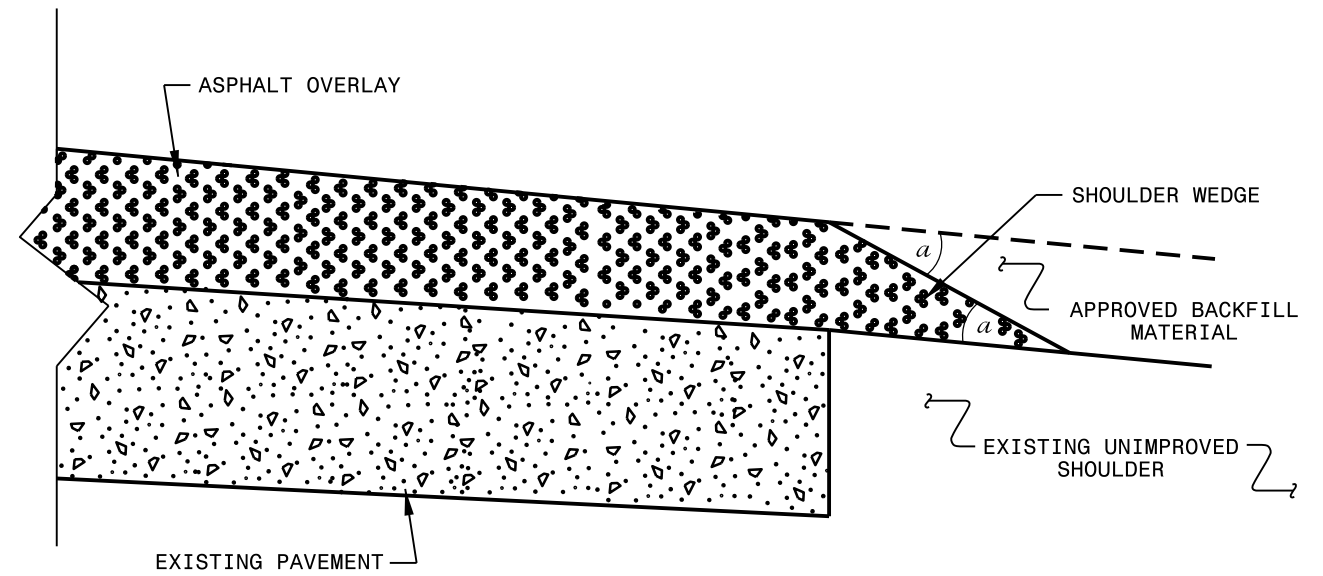

SHOULDER WEDGE DETAIL
(Resurfacing Projects w/ NO Widening)

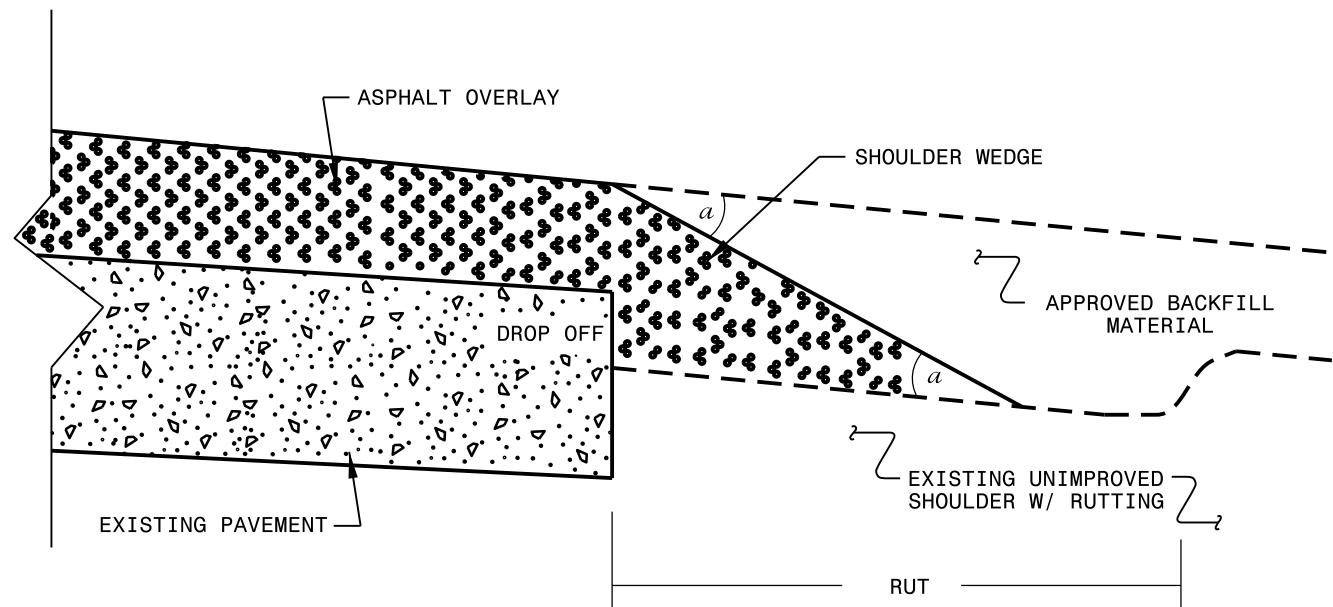

SHOULDER WEDGE DETAIL
(Resurfacing Adjacent to
Rutted Shoulder)

- SHOULDER WEDGE ANGLE = 30°

CONTRACT STANDARDS
AND DEVELOPMENT UNIT
Office 919-707-6950 FAX 919-250-4119

**SHOULDER WEDGE
DETAILS**

ORIGINAL BY: T.SPELL DATE: 7-19-11
 MODIFIED BY: DATE: 10/16/12
 CHECKED BY: DATE:
 FILE SPEC.: susr/details/stand/shoulderwedgedetail.dgn

SIGNING FOR RESURFACING PROJECTS

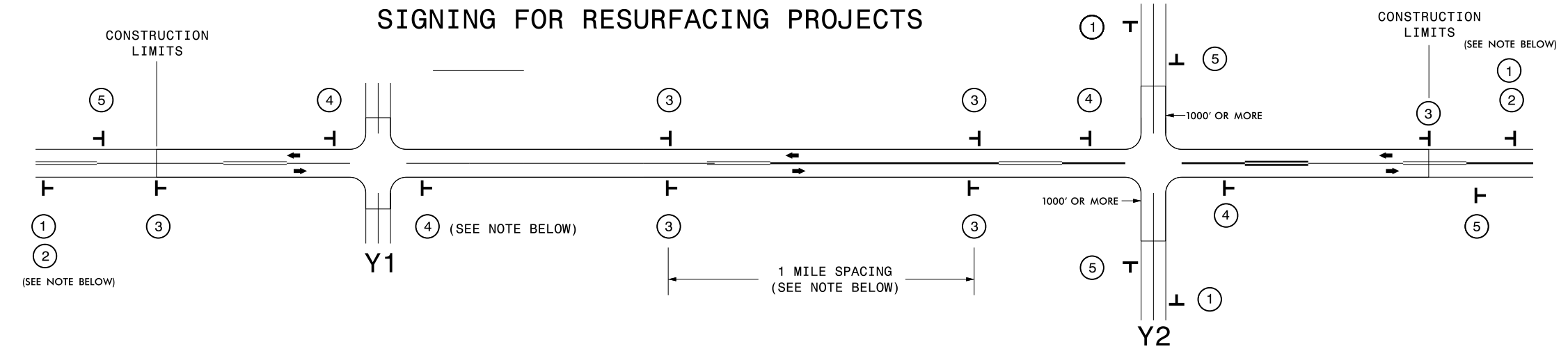

LEGEND	
	STATIONARY SIGN
	DIRECTION OF TRAFFIC FLOW

MAINLINE (-L-) SIGNING

-Y- LINE SIGNING

SIGNING NOTES AND PLACEMENT PER DIRECTION	①	 W20-1 48" X 48" PLACE 1000' PRIOR TO BEGINNING OF CONSTRUCTION LIMITS. ONLY USED ON -Y- LINES IF RESURFACING LIMITS EXTEND 1000' ALONG -Y- LINE.
	②	 W7-3aP 24" X 18" #2 SIGN ONLY USED WHEN RESURFACING LIMITS ARE 2 OR MORE MILES IN LENGTH. ROUND UP TO NEXT WHOLE NUMBER. (NO FRACTIONAL OR DECIMAL NUMBERS)
	③	 SP 13107 48" X 48" PLACE INITIALLY AT THE CONSTRUCTION LIMITS AND SPACED 1 MILE APART THEREAFTER. IF NO -Y- LINES EXIST, PLACE 2ND SET 1/2 MILE FROM THE CONSTRUCTION LIMITS AND THEN SPACE 1 MILE THEREAFTER.
	④	 SP 13106 48" X 48" THESE ARE FOR -Y- LINES THAT ARE "THROUGH" ROADWAYS. DEAD END AND SUBDIVISION ROADS ARE NOT "THROUGH" ROADWAYS. INSTALL 500' +/- FROM EACH -Y- LINE APPROACH AS SHOWN ABOVE. FOR MULTIPLE -Y- LINES THAT ARE SEPARATED BY 0.25 MILES OR LESS, TREAT AS A SINGLE UNIT AND INSTALL WITHIN 500' OF EACH APPROACH. A MAXIMUM OF 2 SIGN SETS PER MILE. DO NOT INSTALL WHEN -Y- LINES ARE WITHIN 0.5 MILES FROM "END ROAD WORK" SIGN.
	⑤	 G20-2 A 48" X 24" PLACE 500' FOLLOWING THE END OF CONSTRUCTION LIMITS.

NO REQUIRED STATIONARY SIGNING FOR THE FOLLOWING -Y- LINE CONDITIONS:

- LESS THAN 1000' OF RESURFACING ALONG -Y- LINE
- SUBDIVISION ROADS
- DEAD END ROADS

WHEN PAVING/CONSTRUCTION ACTIVITIES PROCEED ACROSS AN UNSIGNED -Y- LINE, ADVANCE WARNING PORTABLE SIGNS SHALL BE USED ALONG THE -Y- LINE AS SHOWN BELOW. REMOVE UPON COMPLETION OF WORK.

W20-1
48" X 48"
 PLACED 500' IN ADVANCE OF FLAGGER.

W20-7 A
48" X 48"
 PLACED 250' IN ADVANCE OF FLAGGER.

DRAWN BY: JWC

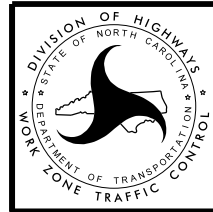

**RESURFACING
ADVANCE WARNING SIGNS
FOR
RURAL AND SUBURBAN
2 LANE ROADWAYS**